

Product Data Sheet



Product Name:

EDMONTON/YUKON Aluminium Stile

Page / Total pages:

1 / 1

Catalogue No:

153207xx

INDECO S.A., ul. Kaczorowa 37, 03-046 Warszawa, tel. (+48 22) 313 0 313, fax. (+48 22) 313 0 314

Date:

2010-09-16

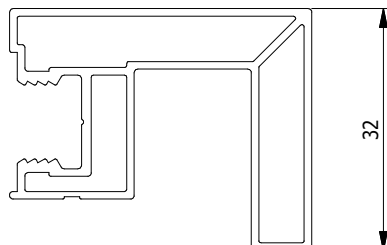

The EDMONTON/YUKON aluminium stile is one of the best-selling INDECO profiles.

The distinctive geometry of the Edmonton profile producing architectural light-and-shade effects will perfectly highlight the sleek simplicity of contemporary design. For enhanced attractiveness, the Edmonton side of the profile is provided with an indentation which additionally emphasizes the character of the profile (see the drawing below).

The austere line of the perfectly smooth Yukon profile harmonizes with the cool colours of the sky and water and with the shine of metal and glass.

The main advantages of the profile include the fact that it is two-sided. This allows two very different door leaves to be assembled with the use of the Edmonton or Yukon side without having to keep extra stock on hand.

To assemble a door leaf, inserts of 4 to 10mm can be used, including glass with safety backing, multilayer laminated safety glass, laminated chipboard, etc.

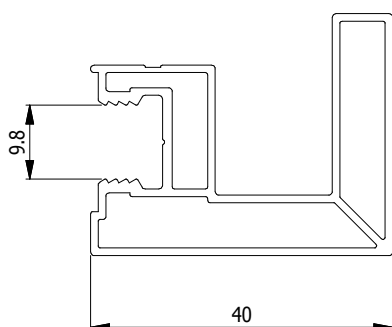

Door leaves made with the use of the Edmonton/Yukon stile feature symmetrical top guides with bearing:
052471LL with z logo INDECO,
052471LO - without logo,
and standard symmetrical top guides 052471.

The Edmonton/Yukon stile is available in the following colours xx:
AS - Natural Anodized
ASZ - Champagne
Profile length: 5.5 m

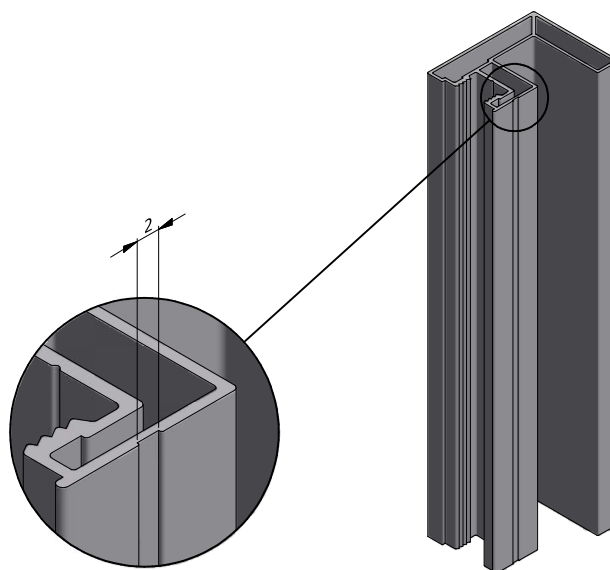

Technical data

Product name:	EDMONTON/YUKON Aluminium Stile
Catalogue number:	153207xx
Application:	H100, A100, A300, A400, A500, A600, A700
Insert thickness:	4 – 10mm
Colours xx:	AS, ASZ
Length:	5.5m
Packaging:	8 pcs/pack

Weight:	~26 kg
Availability:	Continuous